

RKT-105H TRIMMING POTENTIOMETER



- Single Turn/ Phenolic/ Industrial/ Sealed
- 6 Terminal Styles

Electrical Characteristics	
Standard Resistance Range	10Ω - 2MΩ
Resistance Tolerance	±10%, ±20%, ±30%
Residual Resistance	10Ω Maximum
Resistance Taper	Logarithm (A) Linear (B) Anti Logarithm (C)
Rated Power	Linear (B), 0.15W Non Linear (A,C), 0.07W
Operating Voltage	Linear (B), 250VDC Non Linear (A,C), 125VDC
Potational Life	(a) 500 Cycles (b) Long Life: 10,000 Cycles

Mechanical Characteristics	
Rotational Angle	235° ± 5°
Rotational Torque	20~200gf.cm
Stop-end Strength	400gf.cm minimum

Climatic Characteristics	
Operating Temp	-25°C ~ 40°C
Temp Characteristics	+5~ -10% change in NR after 5 hours at 70°C
Humidity Char	Maximum resistance change within ±20% after 500hours unloaded at 40°C and R.H.95%

Soldering Conditions	
Temperature	260°C
Time	3 seconds

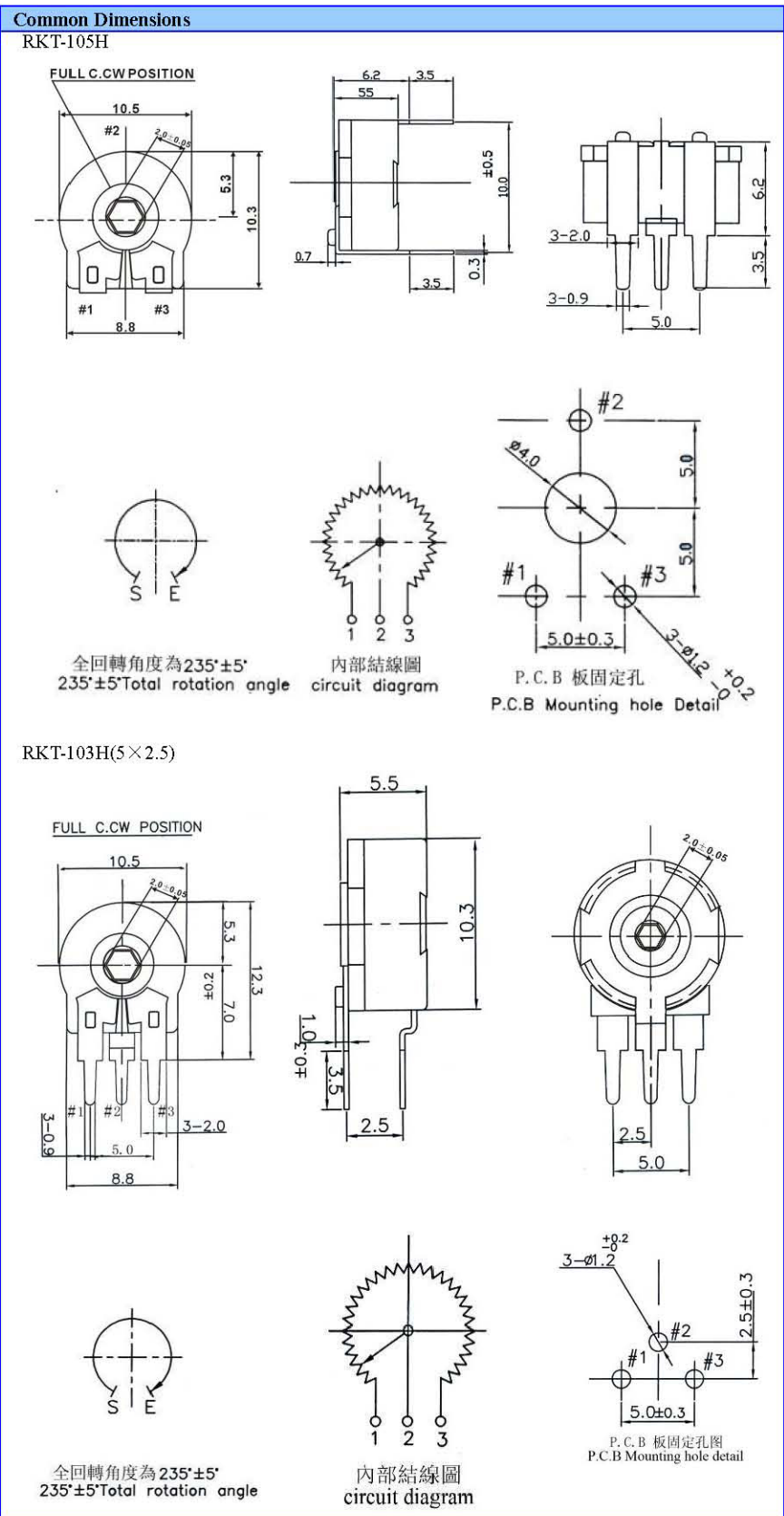

RKT-105H TRIMMING POTENTIOMETER

Common Dimensions

RKT-103H(5×5)

FULL C.CW POSITION

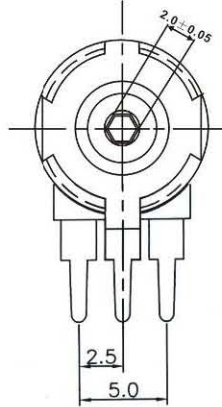
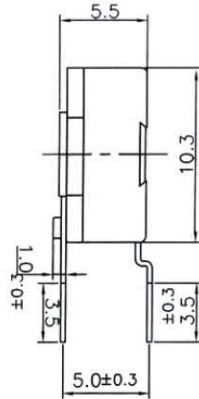
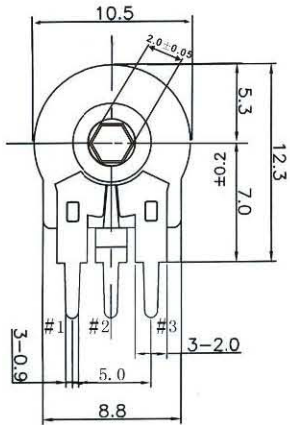

全回轉角度為 $235^\circ \pm 5'$
 $235^\circ \pm 5'$ Total rotation angle

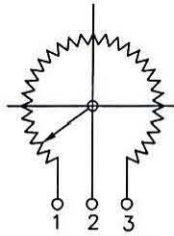

內部結線圖
 circuit diagram

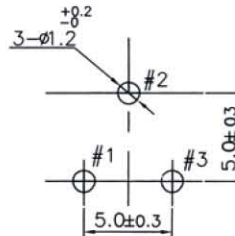

P. C. B 板固定孔圖
 P.C.B Mounting hole detail

Rotors Type For without shaft

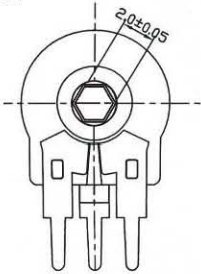

H=HEXAGONAL THRUHOLE
 六角A

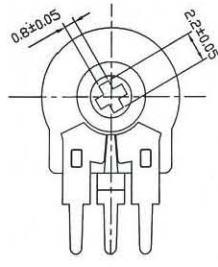

K=CROSS SLOT THRUHOLE
 十字

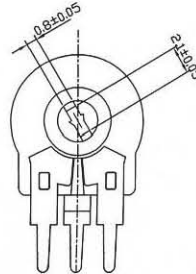

S=SCREWDRIVER THRUHOLE
 一字

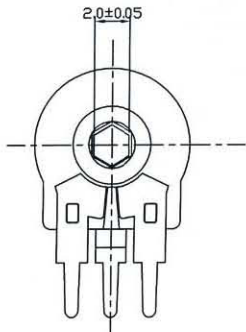

G=HEXAGONAL THRUHOLE
 六角B

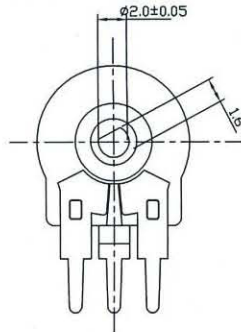

D=SHAPE D " D " THRUHOLE
 D字

How to Order

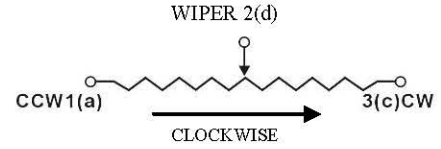
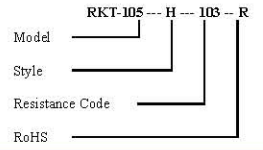

Tolerance is ± 0.25 if no identification

Resistance Table

Resistance(Ohms)	Resistance Code
10	100
20	200
50	500
100	101
200	201
500	501
1,000	102
2,000	202
5,000	502
10,000	103
20,000	203
25,000	253
50,000	503
100,000	104
200,000	204
250,000	254
500,000	504
1,000,000	105
2,000,000	205

Special resistances available.